



PART NUMBER

PFF19-2223

DESCRIPTION

LOWER TORQUE MOUNT

INSTALLATION GUIDE

Contents (parts per pack):

- 2 x Large Polyurethane Bushes
- 1 x Stainless Steel Sleeve
- 2 x Small Polyurethane Bushes
- 1 x Anodised Sleeve
- 1 x Aluminium Bracket
- 1 x Nylon Washer
- 1 x PTFE/ Silicone Grease

Please read the complete fitting instructions and check package components before fitment. These fitting instructions are to be used as a guide and in conjunction with workshop manual.

It is recommended that:

- all work to be carried out by a licensed technician;
- all safety precautions adhered to;
- wheel alignment to be checked and adjusted as required after any suspension work.
- All fasteners must be tensioned to manufacturer's torque settings.

Fitting Instructions:

1. Raise the vehicle on either a lift or on axle stands to gain access to the underside and plastic engine under tray.
2. Remove the engine under tray to locate the Ford torque mount.
3. Undo the 15mm and 16mm bolts to remove the original torque mount.
4. Apply the grease provided to the bore and end faces of the Powerflex bushes prior to installation.
5. Fit the anodised sleeve into the bushes, and place the nylon washer on the exposed end of the sleeve once pushed together.
6. Install the Powerflex torque mount in the same direction as the OE mount i.e. with the head of the large sleeve gearbox side.
7. Re-fit the 15mm & 16mm bolts, tightening them to Ford's recommended torque settings.
8. Re-fit the engine under tray using the retained plastic clips and torx screws.

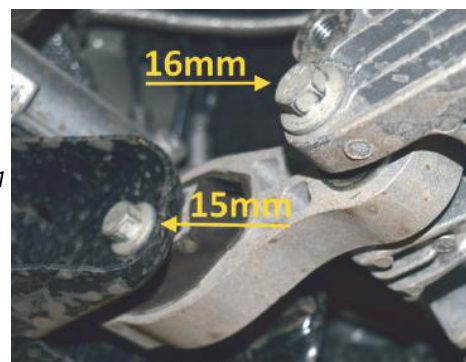
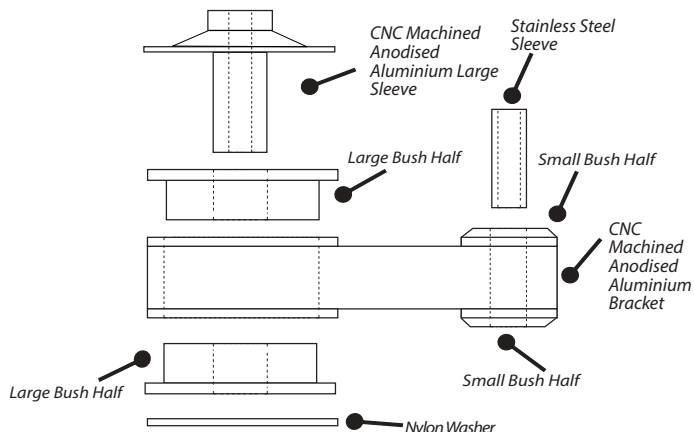

Figure 1



Figure 2

Figure 3 - Assembling the Powerflex Lower Torque Mount



Assembled Mount (Side View)

